



LOVELOCK LINES

The Lovelock Family Newsletter

August 2004

Edited by Yann, with assistance from
John, Jeremy, Graham and Robert

Contents

Editorial	1
Lovelocks Alive 2004 - Graham's account of the family gathering	2
Famous Lovelocks - a guide to the illustrious of that name	4
George Lovelock - the founder's life and a gazetteer of the town of Lovelock, Nevada	6
The Legend of Lovelocks House - John acts as estate agent	9
The Lovelock Collaborative One-Name Study - James Loveluck on how it started	12
Poem by Joy Lovelock & Frances Vasey	19
Editor's Letters	20

Editorial Address: 80 Doris Rd, Birmingham B11 4NF, UK
Tel. 0121 449 6402.

Email lovelock@ynaok.freemove.co.uk

Printed and compiled at Birmingham Buddhist Vihara

Greetings, far-flung cousins!

And welcome to the first issue of our newsletter.

Whether it remains the only one will depend on you. We found we had a bit of money left over from the family gathering in June and, bearing in mind those who wanted to be with us but were unable to come, we decided it might be a good idea to keep in touch with you all this way.

The 'we' in this case is the group of us interested in genealogy who came together to launch the Lovelock Family History website. Genealogy, we know, is a taste not shared by all, however enthralled they are by family history. Perhaps the newsletter can serve us as a half-way house.

We need feedback from you, telling us what you think about the idea. We need articles about family matters from you or suggestions about what we might cover (and who might cover it!) And, of course, if we compile any more issues, we need to agree on a subscription to cover costs and postage.

Please contact us at the address above or via the web site.

LOVELOCKS ALIVE 2004

Graham Lovelock reports:

On Saturday 12 June some seventy members of Lovelock families or their descendants gathered at The Bear Hotel in Hungerford, Berkshire, at an event arranged by John, myself, Janet and Jeremy. Over a year in the planning, it captured the attention of local television and news-papers as well.

People had come from as far away as Australia, South Africa, Canada, Spain and France to join family members from many parts of England and Wales. As well as exchanging family details and stories, we listened to presentations on Lovelock research and the development of their family history internet website from John Lovelock, James Lovelock and Australian enthusiast Robert Sterry.

Lunch followed the presentations and the group then toured several East Wiltshire villages with family connections dating from the early eighteenth century to the twentieth. They included Great Bedwyn, East Grafton, Easton Royal, Wootton Rivers, along with a traverse of Savernake Forest, where fifteenth century Lovelocks were employed by the Seymour family as foresters.

Many new friendships were forged and family relations contacted, some even meeting first cousins for the first time in their lives. All dined together in the evening, entertained by speaker Colin Dean, editor of the Somerset and Dorset Family History Society's magazine.

During the event this newsletter was planned for the particular benefit of those without access to a computer or who could not get to Hungerford, including many in New Zealand, Australia and the United States. It also contains articles not on the website (<http://perso.numericable.fr/~lovjames/family-history/lovelock>) although many more pictures appear there than it is feasible for us to print.



Left:

Second and third cousins Ray, Yann and Penny, great grandsons and great niece of Elijah, by his grave in East Grafton churchyard, 12 June, 2004.

Below:

Robert, Jeremy and James, untraceably distant cousins, united in relief that the day is fine and the coach has not stuck fast in the narrow country lanes.



FAMOUS LOVELOCKS

Jack (John Edward) **Lovelock**, the son of English immigrants, born in a small New Zealand town in 1910. He studied medicine at the University of Otago, then gained a Rhodes scholarship for Exeter College (Oxford) in 1931. In 1932 - by then holder of the British Empire record for the mile - Lovelock competed in the Summer Olympics in Los Angeles. The following year, he set a new world record in the mile: 4.07,6, and in 1934 he won the gold medal in the mile at the British Empire Games. The highlight of his career came in 1936, when he won the gold medal in the 1500 metres at the Berlin Olympics, setting a new world record in the final (3.47,8) not broken until five years later. Afterwards he graduated and became a doctor, serving as a medical officer during World War II. He was tragically killed when he fell under a subway train in New York in 1949. In 1990 a New Zealand postage stamp was dedicated to him. In 2002 a life-size bronze statue was unveiled at Timaru Boys' High School. Here he had been head prefect and athletic champion of the school in the late 1920s. A number of hypothetical links to various Lovelock branches have been made, but none are conclusive. By a singular coincidence, a young American student called Nate Baer came to study at Otago University and took part in a race in 2003. It then turned out that his mother, who died when he was eight, was Jack Lovelock's youngest daughter, Janet. Until informed later by his aunt Mary, he had no idea he was following in his grandfather's footsteps!



James Ephraim (Jim) Lovelock, b. Letchworth Garden City in 1919 of a father originally from Didcot.

An independent scientist and inventor, one of whose inventions led to the discovery of the greenhouse effect.

Educated first in Chemistry then in Medicine, gaining his Ph.D from London School of Hygiene and Tropical Medicine in 1948 and his D.Sc. from London University in 1959. During the 1950s-70s he held a number of visiting appointments in U.S. universities. Elected FRS in 1974.



Achieved world-wide fame as the originator of the *Gaia* hypothesis in 1979, followed by several other books on that theme. Among many later honours was the CBE in 1990. Recently he has fallen foul of conservationists by championing nuclear generated energy. There is no information linking him to any of the known Lovelock branches. More information about James Lovelock can be found at <http://www.ecolo.org/lovelock/>

His daughter is the artist Christine Lovelock whose web page is <http://www.chrislovelock.co.uk> Under other names she has been a champion runner and a romantic novelist.



Rev. Canon Dr Graham Loveluck, b. 1934. Formerly a teacher, he took Holy Orders in 1975 and is now the Welsh-speaking Rector of St Gallgo's church on Anglesey. Until his retirement in 2003 he had been Chair of the Diocesan Directors of Education Group and continues on the governing body of the Church of Wales.

He is a sixth generation descendant, via the eldest surviving son of the Wiltshire-derived line of John Lovelock, whose name was changed by Welsh pronunciation when he settled in Glamorgan. His two sons are the rally driver Aled (b.1965) and the business executive Hywel (b.1967), recently named as 'one of Europe's most dynamic entrepreneurs'.

GEORGE LOVELOCK, 1824-1907

- *the founder of Lovelock, Nevada*

George Lovelock was born March 11, 1824, in Swansea, Wales, but was reared and educated in England. He married Mill Mary Forest in 1847 and shortly afterwards they took ship to Australia, their first son Fredrick being born during the passage.

In Australia George was employed in the copper mines for over two years, after which he and his family embarked for the Sandwich Islands (Hawaii). Leaving his wife and child there, he set sail for San Francisco, California, arriving in April, 1850. George had also learned the carpenter trade and for the first few weeks he was engaged in building houses in Happy Valley. In May he went to Sacramento, where in June he was joined by his wife and son.

Soon after they moved to Brown's Valley, and then to Feather River, where George built the second house in what is now the city of Oroville. His son Thomas was the first white child to be born there, September 1851. Next year he moved to Marysville and then to Butte Creek, where he built a store. The little California town there named Lovelock in his honour still exists.

During his stay in the area he was engaged in placer mining, teaming, and also built a sawmill. At the beginning of the Civil War, however, the demand for lumber ceased and he struck out for Nevada, eventually settling in 1866 where the (second) town of Lovelock has been built. The place was then called the "Big Meadows" and was a welcome stopping point for wagon trains on the California Trail before crossing the forty-mile alkaline desert to the west. At the back of the Humboldt Range, it lies at an elevation of 3,975 feet above sea level.

Upon arriving George bought the squatter's right from the Blake brothers and got with it the oldest water rights on the Humboldt River. He established his home and operated a newly acquired stage station at a point nearly opposite where the old railroad depot now stands. So far as can be determined the Blakes and George Lovelock also completed one of the earliest irrigation canals in the Lovelock Valley. They harvested the Great Basin wild rye growing in the meadows and along the Lovelock Slough with scythes each fall and used or sold the hay.

When the Central Pacific Railroad reached the site two years later, George gave eighty-five acres for a town site which the company named after him. In 1870 it had four stores, three hotels, two saloons, a schoolhouse, a livery stable, and a blacksmith shop. George became the first postmaster for Lovelock in 1875. By 1880, the city had four miles of streets.



Mary Lovelock, George's first wife, mother of his children and sharer in his pioneer hardships, passed away aged 58 in July 5, 1881, leaving eight children: Frederick, Thomas, George Jr., Daniel, Stephen, Nellie Lovelock Carpenter, Jennie Lovelock Ruddell, and Ellen Lovelock. Later George married Mary Evans, who accidentally drowned three years later in the old river channel which passed back of their home. No children were born of the second marriage.

The mountains and hills surrounding Lovelock have more variety of minerals than any similarly sized area in the world. There are huge iron ore deposits, also deposits of gold, silver, copper, mercury, tungsten, gypsum, diatomaceous earth, antimony, sulphur, fluorspar, the platinum group and manganese. Lesser varieties include nickel, arsenic, lead, dumortierite, bentonite, jasper, alabaster, pumice, mica, obsidian, phosphorus, bauxite, titanium, selenium and uranium.

Mining was George's life's work and study. He was one of the first men in the country to engage in mining enterprises and at the time of his death his hold-

ings were quite extensive. He was the discoverer and original owner of the American Nickel Company's nickel and cobalt properties at Cottonwood Canyon and had valuable holdings in many other districts in the country. Hotels were a connected by-line. In Lovelock he first owned the Big Meadow Hotel as well as one in Trinity when that mining town was in its heyday. He also operated a large hotel in the silver town of Oreana.



"Uncle George" was a short stocky man with bush whiskers, extra wide suspenders and a handkerchief around his neck. He is remembered sitting on the porch of his adobe home surrounded by ore samples and the town's children who gathered to hear his stories and admire his collection. His prized possessions were an unusually large pocket watch and chain that he had brought from England; his stogie knife with its long sharp blade which he used to remove corks from various types of bottles; and his miner's eye glass, a tool of his beloved trade. He was never sick a day in his life prior to the three days before his death. He often attributed his longevity to his daily ritual of dipping his penknife into a blue bottle of quinine powder and consuming all its point would hold. This was followed by a cup of the wild sagebrush tea of which he was so fond.

George Lovelock passed away at the age of 83 on March 28, 1907, following an attack of pneumonia. In the delirium of fever the night before, he imagined he was going down mine shafts, a candle in hand. Soon after his death a series of three fires devastated much of the town, which then had some 1,500 inhabitants. There are only a little over 2,000 to this day and major employment industries remain farming, mining and services for travellers.

(Adapted from Elaine Pommerening's account for the Lovelock Centennial Booklet, 1968.

*More information on the town of Lovelock can be found at
<http://www.city-data.com/city/Lovelock-Nevada.html>)*

The Legend of Lovelocks House

John Lovelock

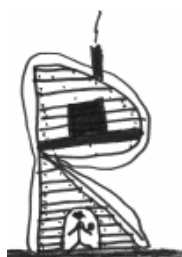

RIGHT from when I first discovered it and for a number of years since I have been curious about a building marked on the Ordnance Survey Map close to Junction 14 on the M4 Motorway and simply called Lovelocks.

The property is approximately three miles north of Hungerford alongside the old Hungerford to Wantage Road (now the A338). This section of road was cut in two when the Motorway was built in the late 1960's and a new road was built approximately a quarter of a mile to the west as part of the Motorway junction. Until at least the early 1980's there was a sign at the junction of the old and new road which stated Lovelocks only!

Curiosity got the better of me two years ago and I contacted Hungerford Library for the full postal address and name of the present occupier from the Electoral Register. I then wrote to enquire about the history of the house and why it was called Lovelocks.

The present owners rang to say that they did not know the origin of the name but there was a carved memorial at the property to Francis Lovelock and I would be welcome to visit to see it. It was carved by Captain Burmester who also carried out a lot of carvings in St Stephens Church at Shefford Woodlands about a mile north of Lovelocks House. The church also includes a stained glass window depicting the property.

In the meantime I carried out research in Hungerford Library and Berkshire Record Office and also contacted the Hungerford Society.

The House

My research indicates that the house was built between 1820 and 1841. The Hungerford Inclosure Award of 1820 indicates that no building was on the site but the land was owned by Francis Lovelock.

Census Records and Local Directories indicate that until the turn of the 20th Century the building was known as Newtown Lodge (Hungerford Newtown is about one mile south). The Property Deeds indicate that the building was renamed Lovelocks House in 1900. The name appears in Kelly's Directory for the first time in 1931.

The 1841 Census lists Charles COXE 60 Clergyman, Eliza his wife 55 (and Francis Lovelock's niece) and children Susan 25 and twins Caroline & Francis 20. The Rev Charles Coxe is listed in Piggot's Directory of 1830 living in Hungerford Newtown and he voted at East Shefford in 1832.

Charles COXE died in February 1846 age 66 and it was probably at this stage that his son James Thring COXE moved into the property as he is listed in the 1848 Kelly's Directory and appears in the Census of 1851 and 1881. He also appears in Kelly's in 1891 and probably remained there until his death (aged 91) in 1900.

The property was unoccupied at the time of the 1901 Census but shortly afterwards was occupied by Captain Arnold Charles BURMESTER. During World War Two Italian POW's were housed on the estate and a Women's Land Army Hostel opened there.

The Lovelock Connection

Francis Lovelock was baptised at St Lawrence Hungerford on the 9th April 1751, the son of Edward and Ann (FRANCIS d 1781) of Lambourne Berkshire (married 31 December 1747). The Lovelock Web site includes the Will of Edward who died in 1780 and his daughter Ann (of Avington - a small parish between Hungerford and Kintbury) in 1785. Francis also had an older brother Edward (baptized 7 March 1748 or 9).

Francis died aged 83 on the 25th April 1834 and was buried at Kintbury Berkshire on the 3rd May 1834. His grave indicates that he lived at the time of his death in Avington.

I recently discovered that Francis's Will is at the National Archives but haven't managed to see it yet. If anyone wishes to take a look too, the Catalogue Reference is PROB 11/1831 Piece Teignmouth Quire Numbers 251- 300. This may reveal who the estate was left to.

The Lovelock and Coxe families were connected by marriage as follows:

On the 27th March 1780 Ann Lovelock (1753 -1785 - sister of Francis) married James BUTLER of Newbury. James and Ann had a daughter Eliza Ann (1783-1866) who on the 8th August 1808 married Charles Batson COXE of East Shefford. Charles COXE later became Rector of Avington and East Shefford.

Eliza and Charles had at least seven children including Francis Lovelock COXE (1817-82) possibly named after Eliza's great Uncle - he later became a JP and lived at Eddington House nearby; James Thring (1817-1900, who lived in Newtown Lodge); and their youngest daughter Caroline Mary.

A plaque in Shefford Woodlands (formerly East Shefford) Church notes that Caroline married Major General Arnold E. BURMESTER. They had a son Captain Arnold Charles (1857-1944) who married Alicia COXE (1857-1946).

A mystery remains

It is still a mystery why Captain Arnold Charles BURMESTER dedicated his carving and probably renamed the house in memory of his Great Great Uncle Francis Lovelock, particularly in view of the fact that Francis died 23 years before he was born.

The Lovelock Collaborative One-Name Study

by James Loveluck, with thanks to Robert Sterry for input and inspiration.

IN this article I'd like to do three things:

- 1) Take a look at how we managed to build up a very fruitful collaboration around the subject of Lovelock family history.
- 2) Take stock of what we've achieved
- 3) Provide some pointers as to what still needs to be done, and some recommendations as to where we might focus our efforts in the coming months so that we have an even more complete picture in time for the next Lovelock gathering!

How I got involved in Lovelock family history

I first became interested in my LovelUck family history in the mid 90's and had a flying start thanks to material inherited from my Aunts and in particular a fairly extensive family tree for the Glamorgan Loveluck family which they had received from a distant cousin, Janet Hearle, née Loveluck, since deceased. Since that time, the basic structure of the Loveluck family tree is unchanged from that established by Janet Hearle over 20 years ago.

The Glamorgan Lovelucks can be traced back to a John Loveluck or Lovelock who married Ann John at Margam, Glamorgan on 23 Nov 1765. Janet Hearle believed that John Lovelock was born about 1740 in Wiltshire, and that he changed his name to Loveluck when he moved to Glamorgan, possibly due to the Welsh pronunciation of the surname. Janet had spent quite a lot of effort trying to locate the said John Lovelock and was in touch with other researchers interested in Lovelock family history, including Gwen Eastment (see below) and maybe Graham Lovelock.

Building on Janet's work I have filled in quite a few details and made some corrections to this tree, and in particular validated sources of information which were mostly missing, but the basic mystery concerning John Lovelock is still unresolved, although I have identified a couple of potential candidates:

- John L bap. 5 Apr 1738 Wroughton
- John L bap. 21 Oct 1739 Ramsbury

As far as I'm aware we don't have marriage or burial records for either of these individuals in Wiltshire, so it is possible that they moved to South Wales.

This isn't the place to expound further on the LovelUck family tree, but anyone interested will find lots of material on the LovelUck Web site:

<http://perso.numericable.fr/~lovjames/family-history/loveluck/>

which includes some notes as to why John Lovelock might have moved from Wiltshire to Glamorgan to work for Lord Talbot, who had estates at Lacock in Wiltshire and at Margam in Glamorgan. There are also some colourful legends of pirates, shipwrecks and even incipient cannibalism!

It should be noted that there are other examples of the Lovelock to Loveluck name change, in particular in the Cardiff branch of the Lyneham Lovelock line – but in this case it happened much later and is thus easier to track down.

Widening the Circle

Having a background in computing I almost immediately started using the Internet to help me in my research, and it was through the Internet that I first got into contact with Robert Sterry – our first email exchange took place on 18 Nov 1997 after I saw a note from Robert on a Web site indicating an interest in Lovelock family history. Later I learned that it was Robert's cousin Gwen Eastment (née Lovelock) who first aroused his interest in family history, and that Gwen had been a frequent correspondent with Janet Hearle (I believe that they even met during a visit of Janet and her husband to Australia). Much of the initial Lovelock material on the Web site came from Gwen's original research, and some of it is still there in one form or another. Since then Robert has been my mentor on matters of family history research and he has also done a wonderful job of extracting Lovelock events from Parish and other records, and gathering this together with material supplied by others to produce our magnificent collection of "Lovelocks by Parish" for different counties. This was particularly precious for me since, living in France, access to British genealogy archives is not easy.

I first produced some family history Web pages in February 1998, but these were initially devoted to my own LovelUck line, and access to them was restricted by password to my immediate family and a few family history collaborators. However, later in 1998 I was egged on by Robert to broaden the focus of the Web pages to a "Lovelock One-name Study" following his example with the "Sterry Worldwide" Web pages – but we're still a long way away from the breadth and depth of Robert's study! Initially, we concentrated on Wiltshire, because of the indications that not only the progenitor of the Glamorgan Lovelucks came from there, but also that it was the Lovelock heartland and possibly where the name originated. Later we branched out to Berkshire and Oxfordshire, motivated by the fact that Robert and Gwen's line had roots in these counties (and, it later turned out, that of John Lovelock), then to Hampshire (with help in particular from Graham Lovelock, with later contributions from Mike & Alison Turner, Colin Borrott-Maloney and Jill Fleming) followed by a number of other counties.

Once I had the Web pages in place, we made contact with quite a few other folks interested in Lovelock family history, including Ben Skeates (AU), Richard Dowd (AU), Shaun Fitzpatrick (AU), Ken Gigg, Malcolm Lovelock, Jack Lovelock (NZ), Peter Frost,

John Gough and Helen Norton. A number of my correspondents (including Gwen Eastment) had sung the praises of a legendary Lovelock researcher by the name of Graham Lovelock, but no-one seemed to have a current email or postal address for him. In the end, it was Graham who discovered the Lovelock Web pages, and sent me a long email message on 26 January 2000, and has been doing so ever since (sending long email messages that is)! Graham very quickly made freely available much of the enormous amount of data that he has accumulated on the Lovelocks, and this considerably enriched the Web pages. It also led to a very long email discussion (lasting over two years altogether) mostly between Graham, Robert and myself about the finer details of the “Lieflock Line”!

The number of folks exchanging emails was by this time fairly substantial (around 20) and after a discussion we agreed it would be a good idea to establish a mailing list, so that messages got sent to everyone who was interested. So in April 2000 I made the necessary arrangements to set up the Lovelock mailing list on the Rootsweb server. For anyone who is not already subscribed, you can do so by sending an email message to: lovelock-l-request@rootsweb.com with just the one word “subscribe” in the body of the message.

Since these early days, many others have contributed material towards enriching the Web site and it’s not possible to list them all here. However, I do try my best to acknowledge all contributions to the Web site, so please let me know of any omissions, which are purely accidental.

What Have we Achieved?

Just in case anyone isn’t already aware of where to look on the Internet, the Lovelock Web site can be found at:

<http://perso.numericable.fr/~lovjames/family-history/lovelock/>

Here are a few statistics concerning the data currently on the site:

- A total of about 27MB of data in 440 files – this is for Lovelocks only, with about the same amount for Lovelucks
- Approximately 4640 collected Lovelock parish records (compiled by Robert Sterry), with separate files for different counties
- Approximately 4800 GRO records, mostly collected by Malcolm Lovelock and Robert Sterry.
- Census records of Lovelocks from the 1841, 1851, 1871, 1881 and 1901 British censuses (although we do not have all records for all years for all counties!)
- A Lovelock gedcom file with 2370 individuals. This is mainly Wiltshire Lovelocks, but also extends into Hampshire and other counties.
- A Berkshire Lovelock gedcom file with 1689 individuals

Remember that the number of records on the Web is slightly lower than the total records collected, due to the fact that I omit details of living individuals on the Web pages. Gedcom files are a standard file format which enables genealogical data to be shared between different genealogy computer programs. All such computer programs are able to import a gedcom file, although the results are not always perfect because the gedcom standard is not always adhered to completely.

In addition to the collections of source records, the Web site also includes information about the Lovelock name, a number of trees and fragments (see below), some notes on “famous Lovelocks”, data on the distribution of Lovelocks derived from the 1881 and 1901 British censuses, some photos of Wiltshire places of interest (mostly provided by Jeremy Lovelock and John Lovelock), a “What’s New” page which describes recent changes and additions, and finally a page with information about the Lovelocks Alive 2004 gathering.

The Lovelock Mailing List

As of 12 August 2004 there are 74 subscribers to the Lovelock mailing list. The following graph showing traffic between April 2000, when the list was set up, and May 2004, just before the Lovelocks Alive '04 athering. Activity is a bit sporadic, but the mailing list has become a very useful communication tool. There is also quite a lot of off-list communication between Lovelock collaborators. The total number of messages rose from 34 in 2000 to 212 last year.

Descendant Trees

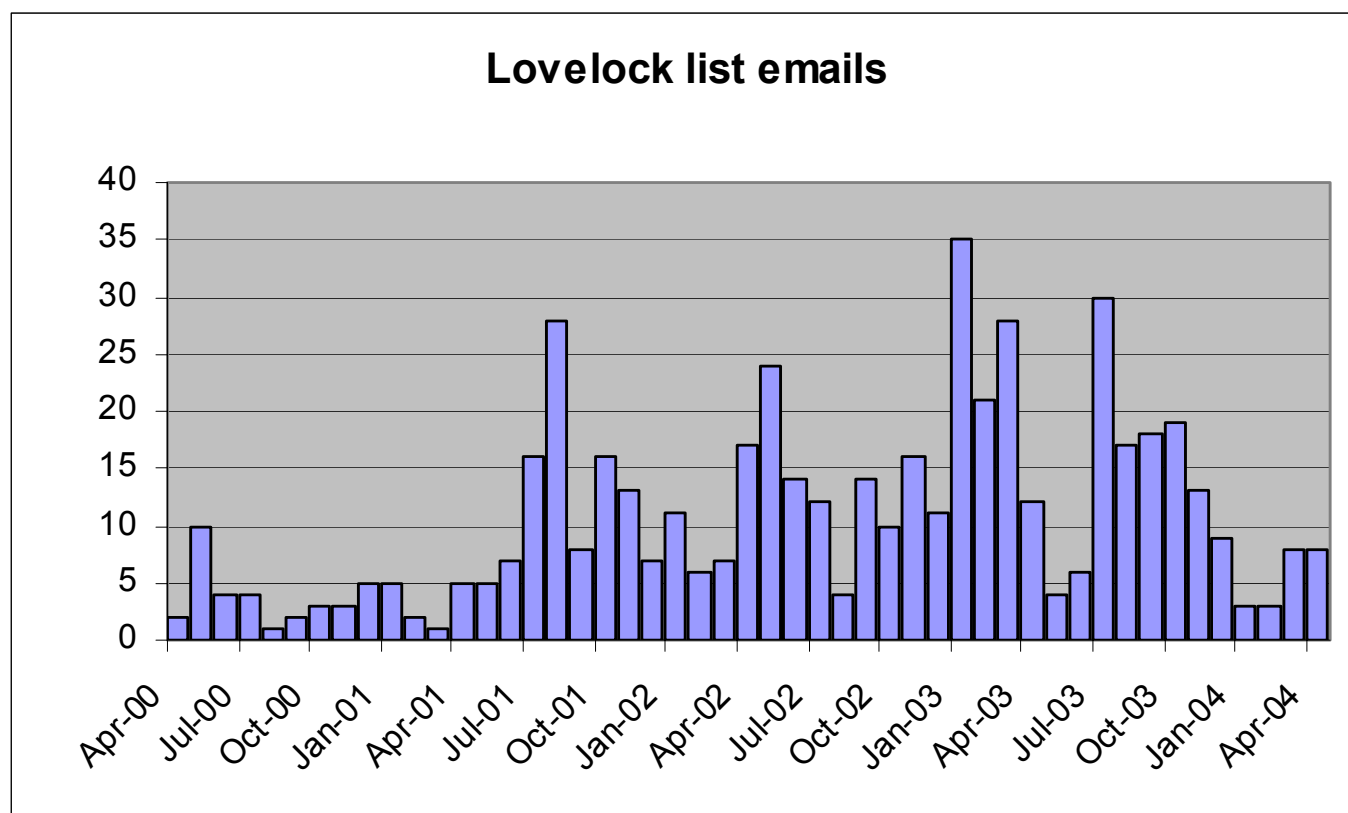

While the source records of Lovelock births, marriages and deaths are an essential resource, most people are interested in constructing family lines in order to understand where they fit into a Lovelock family tree. Building on the early work of Gwen Eastment and Graham Lovelock (much of which is still present in the “Collected Lovelock Fragments”), and with the help of many of the Lovelock collaborators, we have now built up a number of substantial Lovelock Lines, the biggest of which are detailed in the following table:

	No. of entries	No. of Lovelocks
Lieflock line	1034	572
Berkshire line	1689	334
“Fragment 10”	130	83
Lyneham Lovelocks	332	199
Wootton Rivers Lovelocks	78	65
Glamorgan Lovelucks	1420	365

Note that the figures, which correspond to data as of June 2004, are approximate and may change as the tree is modified or added to. The number of entries can differ significantly from the number of Lovelocks, depending on how many female branches are pursued. Thus, the number of Lovelocks in a tree is probably a better metric than the total number of entries. The statistics are for descendant trees of the progenitors, which do not include, for example, ancestors of spouses.

The progenitor of the Lieflock Line is Richard Lovelock who married Mary Head at Preshute on 7 July 1706. Many of the Lovelock collaborators are linked to this line, including Graham Lovelock, Jeremy Lovelock and Malcolm Lovelock. As mentioned above, there has been extensive email discussion of this line, but there are still a few details which are unresolved.

The Berkshire Lovelock Line begins with the marriage of a John Lovelock to Elizabeth Woolf at Reading, Berkshire, on 3 October 1739 and extends into Oxfordshire and Australia! This is the Gwen Eastment/Robert Sterry tree and also includes John Lovelock’s branch.

“Fragment 10” begins with another John Lovelock (born about 1740) who married Elizabeth O’Briant at Collingbourne Kingston in Wiltshire, but is mainly situated in Hampshire. This tree includes Graham Lovelock’s maternal line.

I became interested in the Lyneham Lovelock line because it has a branch which extends into Glamorgan, and I thought it might link up with my Glamorgan Lovelucks, especially since it underwent the same mutation in the surname from Lovelock to Loveluck, but at a much later date than for my Glamorgan Loveluck line. Several folks contributed to this material, including Catherine Lovelock, Graham Wright, Carl Loveluck and more recently Sue Lovelock, who provided new data and insight linking to Etchilhampton, Bishops Cannings and Wroughton, so that the line now extends back to the marriage of Abraham Lovelock to Priscilla Greenaway at Wroughton on 15 July 1689.

The progenitor of the Wootton Rivers Lovelock Line is yet another John Lovelock, who married Mary Winter at Wootton Rivers on 15 October 1739. A number of collaborators have links to this line, and have contributed to the material, including Ben Skeates, Robin and Basil Lovelock, David Lovelock (Arizona USA) and Gil Berrett. There is also a second smaller fragment for Wootton Rivers which has not so far been connected to this main Wootton Rivers Line. In view of the proximity of Wootton Rivers to many of the parishes present in the Lieflock Line, it would seem that there should be a connection between the two, but this has not yet been established.

Stop-press! A revised identification of an individual in this line (as might be expected a John Lovelock!) has led to considerable changes, with the result that a substantial part of this Line is now linked to the Lieflock Line.

The Glamorgan LovelUcks is my own line and as already mentioned extends back to yet another John Lovelock who married Ann John at Margam, Glamorgan on 23 November 1765. In addition to the early research by Janet Hearle, John Thomas and Elizabeth Rushen, many others have contributed to this tree, including John Dixon, Denis Rawlinson, Patricia Davey, Ron Davies, Lynne Davis, and my two Glamoran collaborators Allen Blethyn and Ann Willis to whom I am extremely grateful.

Please let us know, if you haven't already done so, if you are connected to any of the above lines.

Where next?

A fundamental law of genealogy research is that it's never complete, and can probably consume an infinite amount of time and effort! So the best one can do is to define priorities. Of course everyone has their own individual priorities related to their personal Lovelock tree or branch, but here I'll try to define some objectives which I believe will be useful to the overall Lovelock collaboration.

The first of these is to continue to build up the excellent collection of "Lovelocks by Parish". Robert Sterry has been coordinating this activity, and I'm sure we all hope he will continue to do so, but much of the work of actually extracting Lovelock events from parish and other records is currently done by a small band of stalwarts including Robert himself, Graham Lovelock, Malcolm Lovelock, Richard Moore, Ben Skeates, John

Lovelock, Jill Fleming, John Dixon, Mike and Alison Turner, Colin Borrott-Maloney and Helen Norton (my apologies if I missed anyone out). I'm sure that any volunteers would be greatly appreciated!

Another area which needs attention is the "trees and fragments". In fact this covers a multitude of sins. For one thing, the corresponding Web pages need some attention, since they are currently rather badly organised and contain much obsolete or duplicate material, including fragments which have been integrated into larger trees. I hope to get around to doing something about this real soon now. In addition, there is a need to trawl systematically through the collected Lovelock records to identify which individuals are and are not included in the different trees and fragments. Robert and I have made a start on this by flagging in the collected Lovelock files those individuals linked to the Lieflock, Lyneham and "Hampshire" lines. Once this is done we can try to connect up those individuals which are not currently linked to a tree. One objective for this work is to attempt to link the different trees, and in particular to do so across counties – we have already made a start on this with the Lieflock, Berkshire and Lyneham trees, all of which extend beyond one county (and even to other countries!)

The organisation and layout of the Web pages themselves is another area which can always be improved. I recently changed the way one navigates among the Web pages, which most folks seem to agree is an improvement over the previous layout. However, any other suggestions for improvements are very welcome.

Finally, you may have noticed that many of the trees we have assembled terminate with a John Lovelock born somewhere around 1730. If you have information on any of these John Lovelocks please let us all know – I'm particularly interested in one who migrated to Glamorgan sometime before 1765!

Some Conclusions

I've attempted to relate how a collaborative approach to doing genealogy research has developed in a fairly spontaneous way over a period of six or seven years. The goals of the research have gradually evolved over time towards the fairly ambitious one of trying to map out as much as possible of Lovelock family history throughout the UK and beyond (I'm thinking in particular of Australia and New Zealand, but we also have branches extending to the US, Canada and South Africa). This collaborative work, almost exclusively conducted via email, has been very rewarding for me, and friendships have built up from the regular communication with other collaborators. It was quite an experience to meet many of these people, almost all for the first time, at the Lovelocks Alive 2004 gathering in Hungerford last June.

Finally, I have mentioned some of the early and major contributors above, but many other people have contributed to the collective effort I've described and I would like to take this opportunity to acknowledge their contributions. Sharing your bits of information, even if it is limited, is the best way to make sure that the Lovelock trees develop and eventually fit together.

The Lovelock Dynasty

The Lovelocks are a doughty race,
Fine in form and fair of face.
A clarion call went out one day
To see if they could find a way
For all to meet and each to greet
And welcome one another.

They looked around and found a venue,
Routes to follow, and fixed a menu
They came from afar
By plane, train and car
In the quest to find their ancestors.

Friendships were made,
Relations discovered,
History dug into and then uncovered,
Lost lines brought to light of day.

They came together and then departed
With memories shared, friendships started.
What a time they had
All hale and hearty
At the Lovelocks' fantastic family party!

Joy Lovelock & Frances Vasey



Have Lovelocks a genetically inherited condition?

Dystonia is a neurological movement disorder characterized by involuntary muscle contractions which force certain parts of the body into abnormal, sometimes painful movements or postures. Dystonia can affect any part of the body including the arms and legs, trunk, neck, eyelids, face and vocal chords. It is not usually fatal nor does it affect the intellect. I was diagnosed with this genetic disorder four years ago. I have the type that affects the eyes and is called blepharospasm. To my surprise, when I attended the Lovelock Gathering I met another person with the same thing and I wondered if I had inherited it from my Lovelock connections. My neurologist is very interested to see if any other of my Lovelock cousins have this disorder. If you have, perhaps you could contact me either at j.gilmore33@btopenworld.com or 81 Topsham Rd London SW17 8SW. Thank you for your attention.

Jean Gilmore

WRITE A LETTER OF YOUR OWN

Now you've seen it, let us know what you think of our newsletter. Its continuity depends absolutely on your response. We particularly want to know if you would like to receive further issues. Assuming they are about the same size as this, we are thinking of making the subscription £2.00 for UK and £3.00 elsewhere. Please send these to John Lovelock (who is dealing with subscriptions for us) at 13, Coppice Way, Hedgerley, Bucks SL2 3YL or email John.Lovelock@halliburton.com

Assuming we do continue, we have in the pipeline further details of prominent Lovelocks and a feature on the appearance of the surname in literature. The newsletter is not just about genealogy but will allow the family to share news and views together. Many of you are specialists and maybe you'll use your expertise to enlighten us on such matters as the Lovelock Black Hole or the mysterious Lovelock Mummies. Please send copy (or abstracts) to the editorial address on the front of this issue.